

Installation guide

Kitchen module - Mercedes with rail system

ALWAYS close the drawers and lock it before driving! Otherwise the drawers could damage the tower.

1. Installation & Fastening

- The drawers can be taken out in order to reduce the kitchen's weight.

Note: Push the orange clips at the bottom of the drawers simultaneously and take it out (pic. 6).

Variant 1: - Push the front seat fastenings to the front, with the fastening bolts standing parallel (use a screwdriver to push the carriage down and move it).

- Place the kitchen tower behind the driver's seat (in the preferred driving position), with the slots in the bottom of the module over the seat fastening bolts (pic. 1).

- Push the screw hooks through the slots, hook them under the bolts and fasten them hand-tight (pic. 3).

Variant 2: - If the seat fastening is needed for a seat, place the slot nut (a) in the rail, place the kitchen tower behind the driver's seat and fasten it with a countersunk screw (b) into the slot nut (pic. 2+4).

- Place the drawers on the rails and push them into the tower.

- Plug the cable into a 12 Volt socket (pic. 5).

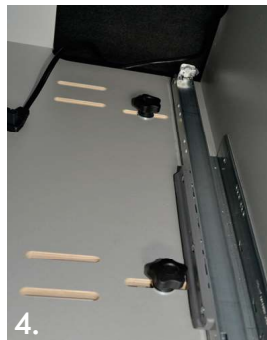
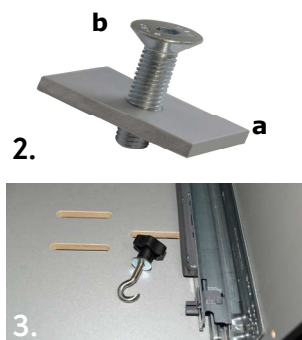

2. Pull-out table

- Open the second drawer and pull the above table out by grabbing the little notch at the bottom (pic. 7).

- Once in a while the table can clamp. If so, push the plate to unlock and then pull again.

- While extended, the table rests on the second drawer. The drawer needs to be pulled out at least half length (pic. 8+9).

- Always insert the drawer first and the table afterwards.

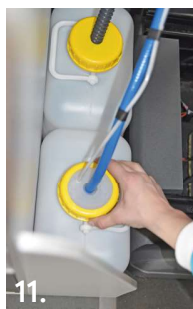

3. Water tank

- For refill/removal of the tanks, push the driver's seat to the front and also flap the backrest (pic. 10).

- Unscrew the cover and remove the tanks (pic. 11).

- Empty water tank and hose completely after touring to avoid frost damage, calcification, bacteria etc..

4. Kitchen tower with toilet

-When using the toilet, place the delivered board in front of the lower drawer to give supplementary stability to the drawer.

- We recommend to place a little rug above the board (pic. 12+13).

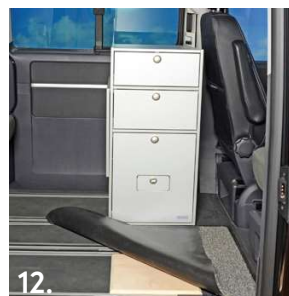

5. Kitchen tower with coolbox

- Place the coolbox on the pullout of the bottom drawer (tilt the box a little to the back).

- Before closing the drawer, plug in the 12V-cable to the coolbox - the access to the back of the coolbox is unhandy if the drawer is engaged.

- Draw the included spring with the screw in one of the threads at the back of the coolbox, then hang the spring into the cable. This avoids the cable to be clamped (pic. 14).

- We recommend not to prolong the included 12V-cable.

If you have any further questions please do not hesitate to contact us:
+49 (0) 8063 / 20 760 - 0 or info@vanessa-mobilcamping.de