

# Installation guide

## Bed system

### Mercedes Marco Polo Activity/Horizon

VanEssa  
mobilcamping

#### 1. Rear board installation

- Mount adjusting screws (front) and wooden plates (rear) to the underside of the rear board angles (pic. 1).
- Loosen the screws of the fastening carriage for the original bed extension and push them as far as possible to the rear. Fasten them again (pic. 3).
- Remove the right panel of the original bed extension (pic. 4).
- Place the slot nuts (a) in the rail system (pic. 2) and position the rear board over the slot nuts.
- Fasten the included countersunk screws (b) through the rear bore holes into the slot nuts.
- Mount the lateral adjusting screw on the left side until it is fixed with the vehicle lining.

*Note: Depending on your car's model there's an adjusting screw to remove on the right side.*

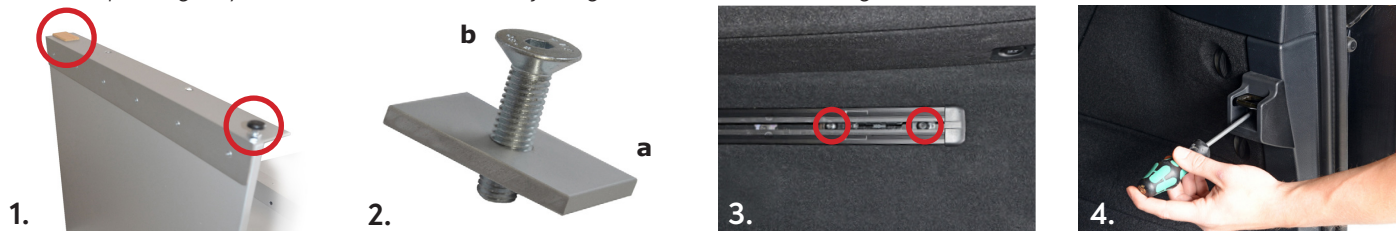

#### 2. Bed system assembly

- With the short wheelbase (Compact version) the rear seat bench has to be removed.
- Hang the two-part folding board into the connection points on the back side of the rear board and place the board on the unfolded bracket H (pic. 5).
- Place the folding bracket V in the passenger compartment, unfold the folding board and place on the bracket (pic. 6).
- Note: To close the bracket, press the feather buttons and flap the feet into the aluminium profile.*
- For extra stability, fix the shoe with the hammerhead screw (front pillar, pic. 10) respectively with a countersunk screw and slot nut (rear pillar, compare rear board installation) in the rail and stand the pillars in them (pic. 11).
- Unfold the mattress into the passenger compartment...and have a good sleep on our cosy VanEssa bed (pic. 7)!

#### With triple seat bench and single seats:

- Hang the two-part folding board into the connection points on the back side of the rear board and place the board on the folded triple-seat bench (pic. 8).
- Place the closed folding bracket V on the single-seats, with the non-slip dots facing upside.

#### With single seats (back, front or both):

- Hang the folding board into the connection points of the rear board and - depending on number/position of the seats - place it on the folded or unfolded bracket H (non-slip dots upside).
- Depending on number/position of the seats, place the folding bracket V either unfolded in the passenger compartment or folded with the non-slip dots upside on the seats and unfold the second part of the board (pic. 9).



#### 3. Storing

While driving with the sleeping board in storage position, make sure that the bore holes on are engaged in the fittings of the rear board - especially when it is used without any seats. As an additional fastening, you can fix board and mattress with tension belts (pic. 12).

If you have any further questions please contact us:  
+49 (0) 8063 / 20 760 - 0

VanEssa mobilcamping | Lauser Strasse 27 | 83620 Grosshöhenrain | Germany  
Tel. +49 (0) 8063/20 760-0 | info@vanessa-mobilcamping.de

