

Installation guide

Module tower - Vivaro B life/Trafic III Spaceclass

VanEssa
mobilcamping

ALWAYS close the drawers and lock it before driving! Otherwise the drawers could damage the tower.

1. Installation & Fastening

- Remove the drawers of the module tower to reduce weight.

Note: Push the orange clips at the bottom of the drawers simultaneously and take it out (pic. 6).

Variant 1: - Push the front seat fastenings to the front, with the fastening bolts standing parallel (use a screwdriver to push the carriage down and move it).

- Place the tower module behind the driver's seat (in the preferred driving position), with the slots in the bottom of the module over the seat fastening bolts (pic. 1).

- Push the screw hooks through the slots, hook them under the bolts and fasten them hand-tight (pic. 3+4).

Variant 2: - If the seat fastening is needed for a seat, place the slot nut (a) in the rail, place the module tower behind the driver's seat and fasten it with a countersunk screw (b) into the slot nut (pic. 2).

- Now you can place the drawers on the rails and push them into the tower. It will automatically click in position.

- Module with coolbox pullout: Put the cable from the tower into a 12 Volt socket (pic. 5).

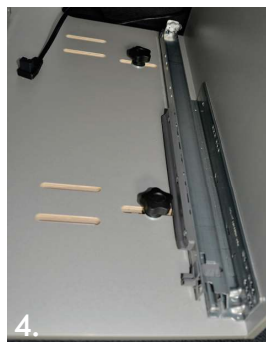
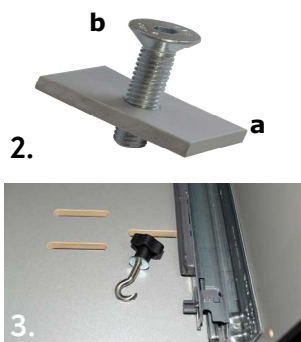

2. Pull-out table

- Open the second drawer and pull the above table out by grabbing the little notch at the bottom (pic. 7).

- Once in a while the table can clamp. If so, push the plate to unlock and then pull again.

- While extended, the table rests on the second drawer. The drawer needs to be pulled out at least half length (pic. 8+9).

- Always insert the drawer first and the table afterwards.



3. Additional top cabinet

Place the top cabinet on the tower and use the two knurled screws to fix it (pic. 10-12).

In addition, fasten the attachment with a lashing strap to the headrest of the driver's seat (pic. 13+14).



4. Module tower T2

When using the toilet, place the delivered board in front of the lower drawer to give supplementary stability to the drawer (pic. 15+16).

Tip: We recommend to place a little rug above the board.



5. Module tower with coolbox pullout

- Place the coolbox on the pullout of the bottom drawer (tilt the box a little to the back).

- Before closing the drawer, plug in the 12V-cable to the coolbox.

- Draw the included spring with the screw in one of the threads at the back of the coolbox, then hang the spring into the cable. This avoids the cable to be clamped (pic. 17).

- We recommend not to prolong the included 12V-cable.

If you have any further questions please do not hesitate to contact us: +49 (0) 8063 / 20 760