

Installation guide

Surfer bed with splitting option

Mercedes Viano/V-Klasse/Vito with rail system



1. Rear board installation

- Screw the adjusting screws into the threads on the underside of the rear board angles and stick the two wooden plates onto the angles (pic. 1).
- Place the slot nuts (a) in the rail system (pic. 2) and position the rear board over the slot nuts.
- Fasten the included countersunk screws (b) through the rear bore holes into the slot nuts (pic. 3).
- Mount the lateral adjusting screw on the left side until it is fixed with the vehicle lining (pic. 4).

Note: Depending on your car's model there's an adjusting screw to remove on the right side.

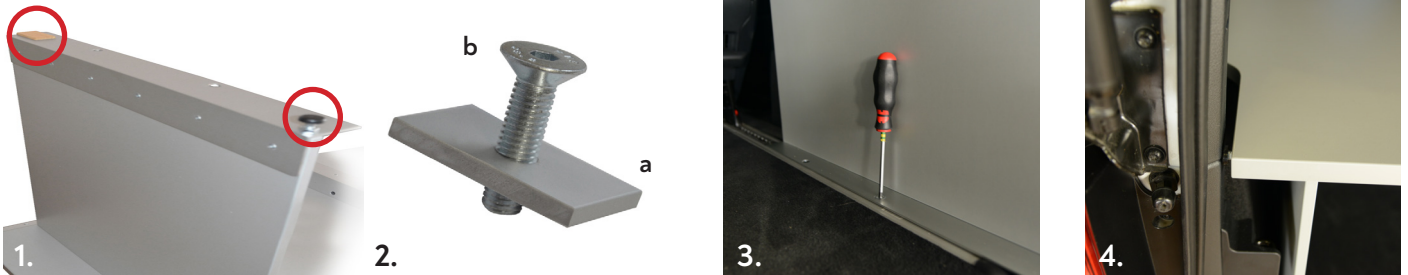

2. Bed system assembly

- Flap triple-seat bench or single seat and position them about 10cm away from the rear board.
- Lift the front edge of the sleeping board a little and pull it into the passenger compartment until it engages in the connection points. The wooden pillar swings out automatically (pic. 5/8).
- Unfold the mattress(es) into the passenger compartment...and have a good sleep on our cosy VanEssa bed (pic. 6/9).



3. Storing

While driving with the sleeping board(s) in storage position, make sure that the bore holes on the bottom are engaged in the fittings of the extension board - especially when it is used without any seats (safety reasons). As an additional fastening, you can fix board(s) and mattress(es) with tension belts (pic. 7/10).

If you have any further questions please contact us: +49 (0) 8063 / 20 760 - 0

VanEssa mobilcamping | Lauser Strasse 27 | 83620 Grosshöhenrain | Germany
Tel. +49 (0) 8063/20 760-0 | info@vanessa-mobilcamping.de