

Installation guide

V1 low kitchen - VW T5/T6/T6.1 Beach

VanEssa
mobilcamping

1. Installation (figures with higher kitchen, but technically no difference)

- Remove the left and right drawers of the kitchen to reduce weight. To remove the drawers just press the orange clips and pull out the drawers (pic. 6).
- Place the kitchen in the back of the vehicle (pic. 1-3). For convenient installation we recommend our mounting trolley.
- The position for the kitchen is 11 cm (T5/T6/T6.1 Beach) from the edge of the door sill protection (pic. 5).

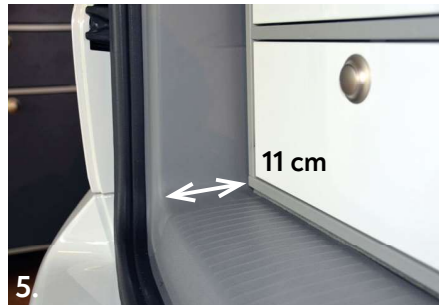

2. Fastening

- Place the kitchen with the rear slots precisely above the airline rails (pic. 7).
- Put the T of the hammerhead screw through the slots into the rails. Hold the T in this position using the neoprene washer while tightening the star knob screw (pic. 8+9).

Note: The hammerhead screws are being anchored shifted in the notches of the indentation on the underside of the airline rails. Therefore the T of the hammerhead screws doesn't engage exactly in a 90° angle.

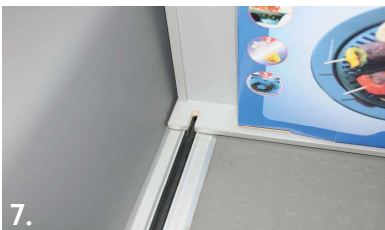

3. Electrics & Water tank

- Plug the cable from the kitchen into a 12 Volt socket. Draw the included spring with the screw in one of the threads at the back of the coolbox. The spring holds the cable up and thereby avoids the cable to be clamped (pic. 10+11).
- The opening lid must be adjacent to the fridge/freezer. The water hose has to be placed like a loop (pic. 12).
- Empty water tank and hose completely after touring to avoid frost damage, calcification, bacteria etc..



If you have any further questions please do not hesitate to contact us:
+49 (0) 8063 / 20 760 - 0 or info@vanessa-mobilcamping.de

VanEssa mobilcamping | Lauser Strasse 27 | 83620 Grosshöhenrain | Germany
Tel. +49 (0) 8063/20 760-0 | info@vanessa-mobilcamping.de